

STORMWATER FLOWS

- STORMWATER FLOWS TO FIRST FLUSH PIT
- STORMWATER FLOWS TO ENVIRONMENTAL FARM WASTEWATER MANAGEMENT SYSTEM VIA COLLECTION PITS
- STORMWATER FLOWS TO COLLECTION PITS, THEN PUMPED TO FARM IN SMALL STORM EVENT AND RELEASED TO RIVER AFTER HEAVY RAINFALL
- PROPOSED FLOUR MILL & ADDITIONAL STORAGE SILO NOVEMBER 2006

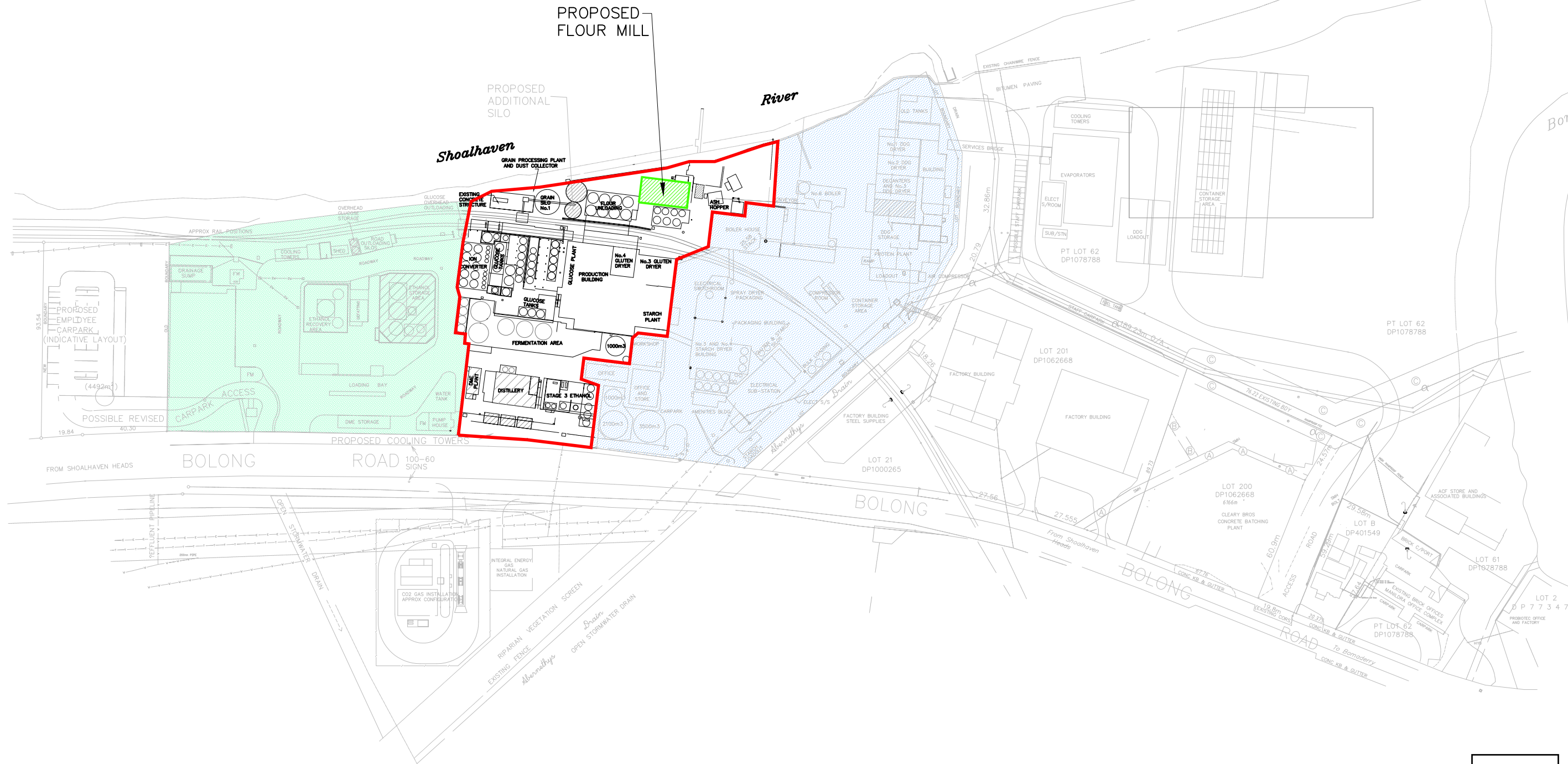

Figure 7

PRELIMINARY

No	Revision	Note: * indicates signatures on original issue of drawing or last revision of drawing	Drawn	Checked	Approved	Date

Plot Date: 28 March 2007 - 1:21 PM Cad File No: G:\23\11989\CADD\Drawings\Environmental\23-11989-FIG001-RA.dwg

0 10 20 30 40 50m
SCALE 1:1000 AT ORIGINAL SIZE

**CLIENTS | PEOPLE | PERFORMANCE**

1/51 Graham Street Nowra NSW 2541
T 61 2 4424 4900 F 61 2 4424 4999
E noamail@ghd.com.au W www.ghd.com.au

DO NOT SCALE

Conditions of Use.
This document may only be used by GHD's client (and any other person who GHD has agreed can use this document) for the purpose for which it was prepared and must not be used by any other person or for any other purpose.

Drawn	DY	Designed	JE
Drafting	JE	Design	JE
Check		Check	
Approved	JE		
Date	15/03/07		
Scale	AS SHOWN		

This Drawing must not be used for Construction unless signed as Approved

Client	MANILDRA GROUP
Project	SHORT FLOUR MILL ENVIRONMENTAL ASSESSMENT
Title	SITE STORMWATER MANAGEMENT PLAN
Figure	FIGURE 2
Original Size	A1
Drawing No:	23-11989-FIG002
Rev:	A